

## APPLICATION

- Gas Solenoid Valves are used for safety and control of gas for shut-off in gas feed pipes
- Suitable for various gasses, including Natural gas, Propane and LPG
- ¼" Inlet and outlet plugs suitable for CPI switch, pressure guage, connection to proving and interlock systems

## OPERATION AND INSTALLATION

- Two-way, normally-closed – energise to open.
- Rapid opening.
- Mounting direct on pipeline more or less 90 degrees (max) from the vertical axis.

## TECHNICAL SPECIFICATION

- Opening time <1 second.
- Closing time <1 second.
- Max number of operations : 20 per minute.
- ¼" Inlet and outlet plugs.
- Incorporated AISI 303 steel mesh filter.
- Cable entry gland PG11 Live, Neutral, Earth.
- Protection to IP54
- NBR based seal with a strong resistance to hydrocarbons (UNI 4916-74).
- Bodies and flanges in diecast aluminium.
- AISI 302 steel pressure spring.
- Chromate Fe 37 steel armature.
- Ambient temperature -15°C to 60°C.  
Coil temperature about 70°C

## STANDARDS AND APPROVALS

- Class "A" BS EN161:2002 Approved.
- British Gas & European Standards.
- 90/396/EEC - 73/23/EEC - 89/336/EEC .
- Certificate CE EC-87/07/009.

## ELECTRICAL SPECIFICATION

- Supply voltage 230V (+10%-15%) 50-60Hz.  
24 Vac.
- Coils to Class F, 360° rotation, suitable for permanent excitation.

## NORMALLY CLOSED - 230VAC

TYPE	SIZE	CONNECTION	MAX PRESS.	POWER VA
ZEV10	3/8"	BSP	350 mbar	20
ZEV15	1/2"	BSP	350 mbar	20
ZEV20	3/4"	BSP	200 mbar	25
ZEV25	1"	BSP	200 mbar	25
ZEV32	1 1/4"	BSP	200 mbar	50
ZEV40	1 1/2"	BSP	200 mbar	50
ZEV50	2"	BSP	200 mbar	50
ZEV65	2 1/2"	BSP	200 mbar	68
ZEV80	3"	BSP	200 mbar	68
ZEVF65	65mm (2 1/2")	Flanged PN16	200 mbar	68
ZEVF80	80mm (3")	Flanged PN16	200 mbar	68
ZEVF100	100mm (4")	Flanged PN16	200 mbar	170
ZEVF125	125mm (5")	Flanged PN16	200 mbar	290
ZEVF150	150mm (6")	Flanged PN16	200 mbar	290

## NORMALLY CLOSED - 24VAC

TYPE	SIZE	CONNECTION
ZEV10F	3/8"	BSP
ZEV15F	1/2"	BSP
ZEV20F	3/4"	BSP
ZEV25F	1"	BSP
ZEV32F	1 1/4"	BSP
ZEV40F	1 1/2"	BSP
ZEV50F	2"	BSP
ZEV65F	2 1/2"	BSP
ZEV80F	3"	BSP
ZEVF65F	65mm (2 1/2")	Flanged PN16
ZEVF80F	80mm (3")	Flanged PN16

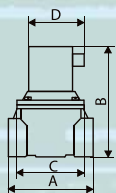

Type	A	B	C	D
ZEV10	72	112	52	85
ZEV15	72	112	52	85
ZEV20	86	156	70	96
ZEV25	100	156	75	96
ZEV32	150	214	110	118
ZEV40	150	214	110	118
ZEV50	170	220	135	123
ZEV65	220	290	170	145
ZEV80	220	290	170	145

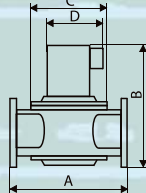

Type	A	B	C	D
ZEVF65	310	343	200	148
ZEVF80	310	343	200	148
ZEVF100	350	384	250	185
ZEVF125	400	592	300	250
ZEVF150	480	630	300	250

ZEV20



ZEV50



ZEV65



ZEVF100

