

APPLICATION

- Gas Solenoid Valves are used for safety and control of gas for shut-off in gas feed pipes
- Suitable for various gasses, including Natural gas, Propane and LPG
- ¼" Inlet and outlet plugs suitable for CPI switch, pressure gauge, connection to proving and interlock systems

OPERATION AND INSTALLATION

- Two-way, normally-closed – energise to open.
- Rapid opening.
- Adjustable flow rate regulator on top of the coil.
- Mounting direct on pipeline more or less 90 degrees (max) from the vertical axis.

TECHNICAL SPECIFICATION

- Opening time <1 second.
- Closing time <1 second.
- Max number of operations : 20 per minute.
- ¼" Inlet and outlet plugs.
- Incorporated AISI 303 steel mesh filter.
- Cable entry gland PG11 Live, Neutral, Earth.
- Protection to IP54
- NBR based seal with a strong resistance to hydrocarbons (UNI 4916-74).
- Bodies and flanges in diecast aluminium.
- AISI 302 steel pressure spring.
- Chromate Fe 37 steel armature.
- Ambient temperature -15°C to 60°C.
Coil temperature about 70°C

STANDARDS AND APPROVALS

- Class "A" BS EN161:2002 Approved.
- British Gas & European Standards.
- 90/396/EEC - 73/23/EEC - 89/336/EEC .
- Certificate CE EC-87/07/009.

ELECTRICAL SPECIFICATION

- Supply voltage 230V (+10%-15%) 50-60Hz.
- Coils to Class F, 360° rotation, suitable for permanent excitation.

NORMALLY CLOSED - 230VAC

TYPE	SIZE	CONNECTION	MAX PRESS.	POWER VA
ZEVR10	3/8"	BSP	350 mbar	20
ZEVR15	1/2"	BSP	350 mbar	20
ZEVR20	3/4"	BSP	200 mbar	25
ZEVR25	1"	BSP	200 mbar	25
ZEVR32	1 1/4"	BSP	200 mbar	50
ZEVR40	1 1/2"	BSP	200 mbar	50
ZEVR50	2"	BSP	200 mbar	50
ZEVR65	2 1/2"	BSP	200 mbar	68
ZEVR80	3"	BSP	200 mbar	68

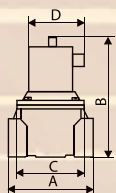

Type	A	B	C	D
ZEVR10	72	121	52	85
ZEVR15	72	121	52	85
ZEVR20	86	168	70	96
ZEVR25	100	168	75	96
ZEVR32	150	233	110	118
ZEVR40	150	233	110	118
ZEVR50	170	260	135	123
ZEVR65	220	330	170	145
ZEVR80	220	330	170	145

ZEVR15



ZEVR50

